

# AIR COMMANDER™ AIR DISTRIBUTOR

with MASTER CONTROL and UNIVERSAL SEQUENTIAL

Page 2 of 3

## PARTS LIST

Universal representation applicable to all versions. Quantities per and components required dependent on assembly being repaired.

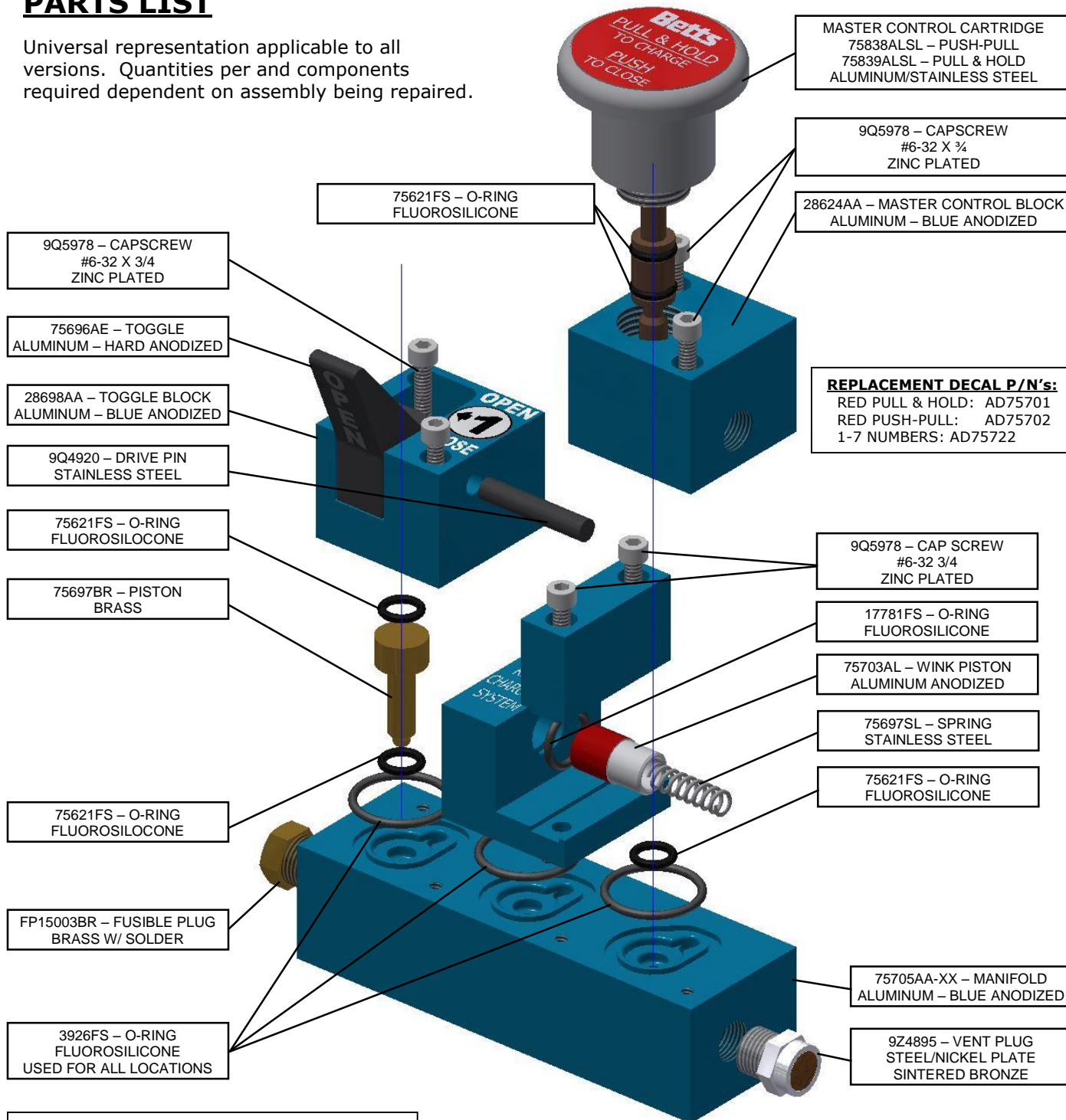

MASTER CONTROL CARTRIDGE  
75838ALSL – PUSH-PULL  
75839ALSL – PULL & HOLD  
ALUMINUM/STAINLESS STEEL

9Q5978 – CAPSCREW  
#6-32 X 3/4  
ZINC PLATED

28624AA – MASTER CONTROL BLOCK  
ALUMINUM – BLUE ANODIZED

75621FS – O-RING  
FLUOROSILICONE

9Q5978 – CAPSCREW  
#6-32 X 3/4  
ZINC PLATED

75696AE – TOGGLE  
ALUMINUM – HARD ANODIZED

28698AA – TOGGLE BLOCK  
ALUMINUM – BLUE ANODIZED

9Q4920 – DRIVE PIN  
STAINLESS STEEL

75621FS – O-RING  
FLUOROSILOICONE

75697BR – PISTON  
BRASS

**REPLACEMENT DECAL P/N's:**  
RED PULL & HOLD: AD75701  
RED PUSH-PULL: AD75702  
1-7 NUMBERS: AD75722

9Q5978 – CAP SCREW  
#6-32 3/4  
ZINC PLATED

17781FS – O-RING  
FLUOROSILICONE

75703AL – WINK PISTON  
ALUMINUM ANODIZED

75697SL – SPRING  
STAINLESS STEEL

75621FS – O-RING  
FLUOROSILOICONE

75621FS – O-RING  
FLUOROSILICONE

FP15003BR – FUSIBLE PLUG  
BRASS W/ SOLDER

75705AA-XX – MANIFOLD  
ALUMINUM – BLUE ANODIZED

3926FS – O-RING  
FLUOROSILICONE  
USED FOR ALL LOCATIONS

9Z4895 – VENT PLUG  
STEEL/NICKEL PLATE  
SINTERED BRONZE

**WARNING:** Use only genuine Betts replacement parts. Use of substitute parts can impair the proper functioning of this product.



Designed, engineered and manufactured in the USA. 